

- NENUTEC is proud to offer the NVCS Screwed End Control Valve. These valve are mainly use in the HVAC system to regulate the flow of water and steam in response to the demand of a controller.
- Complete range from DN 15 to DN 50
- 2 Way Normally Open, 3 Way Mixing and Diverting
- Forged brass body or Stainless Steel
- Low leakage factor of up to 0.05%
- High close-off pressure actuator satisfies demanding requirements of high-rise buildings and high-pressure pumping systems
- PN 16 or 232 PSI system operating pressure
- Actuator can be factory or field installed
- Equal Percentage Flow Characteristic

Specifications

Valve Body Pressure Rating	232 psig (PN16 or 1,600 kPa) Meets Requirements of ANSI B16.15, Class 250		
Fluid / Ambient Temperature Limits	2 to 120 °C water at an Ambient Temperature of 40 °C 2 to 180 °C water / steam at an Ambient Temperature of 40 °C (With Cooling Fin)		
Shipping & Storage Temperature Limits	-40 to 70 °C (-40 to 158 °F)		
Body Sizes	See Table 1: Valve Code Number Selection Guide		
Service	Chilled, Hot Water and Steam, up to 50% Glycol Solutions		
Seat Leakage	0.05%		
Pipe Connection	BSP or NPT		
Body Materials	Brass	Body Stem Seat Seal	Forged Brass Stainless Steel Stainless Steel PTFE
	Stainless Steel	Body Stem Seat Seal	Stainless Steel Stainless Steel Stainless Steel PTFE
Valve Stroke	Brass	DN 20 to 50	20 mm
	Stainless Steel	DN 15, DN20 DN 25, DN32 DN 40, DN50	15 mm 16 mm 19 mm
Maximum Close off Pressure	See Tables 2		

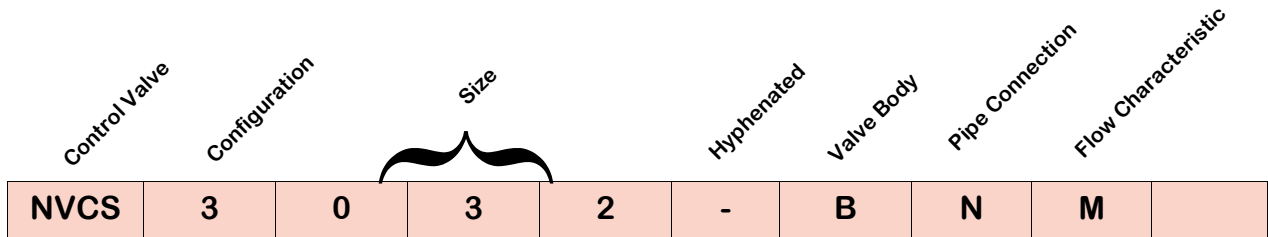

Valve Code Number Designations

Valve Body Type
VB = NVCS Screwed valve body
Configuration
2 = 2-way 3 = 3-way
Valve Size
015 = DN 15 020 = DN 20 025 = DN 25 032 = DN 32 040 = DN 40 050 = DN 50
Valve Body
B = Brass Body S = Stainless Steel Body C = Stainless Steel Body with Cooling Fin (Steam)
Pipe Connection
N = NPT B = BSP
Flow Characteristic (For 3 Way Valve Only)
M = Mixing (2 in, 1 out) D = Diverting (1 in, 2 out)

To Order

Specify the code number from the Valve Code Number Selection Guide.

Repair Parts

Available repair parts for NVCS Series Valves include replacement valve bodies and replacement actuators. No other field repairs should be attempted.

Table 2 : Flow Rate, KV Factor and Maximum Close-off Pressure (KPA) for PDTC 2 Way and 3 Way Electrically Actuated Valves

VALVE SIZE (mm)	Trim	DN15/DN20	DN25	DN32	DN40	DN50
Flow Rate (KV)		6.3	10	16	25	40
Valve Stroke (mm)	Brass	20				
	Stainless Steel	10	16		19	
Stroke Time (Sec)		90			110	
Maximum Shutoff Pressure (KPA)						
Model	Force (N)	DN15/DN20	DN25	DN32	DN40	DN50
NAV..... – 05	500	1000	680	420	240	NA
NAV..... -- 10	1000	NA	NA	550	400	270

Flow Characteristics

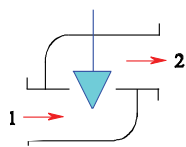

2 Way Valve PTDC

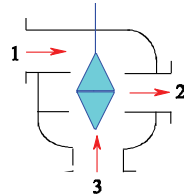

3 Way Valve Mixing

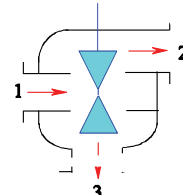

3 Way Valve Diverting

Application Overview

The NVCS control Valve feature both Brass and Stainless Steel Trim and are available in two-way configurations with Push-Down-to-Close (PDTC – normally open) with threaded NPT or BSP. The Valve can be ordered with NENUTEC Valve Actuator NAV... and NTC controller for a complete HVAC solution.

Table 3 : Dimensions of Valve Body (mm)

Trim	DN (mm)	L	H	H1	H2	H3
Brass	20	80	170	21-31	15	40
	25	110	183	21-31	20	62
	32	120	186	21-31	20	62
	40	130	200	13-23	20	74
	50	145	211	13-23	20	77
Stainless Steel	15 / 20	80	115	40	7	25
	25	105	125	40	12	30
	32	120	155	40	16	35
	40	130	165	40	19	40
	50	150	190	40	19	55

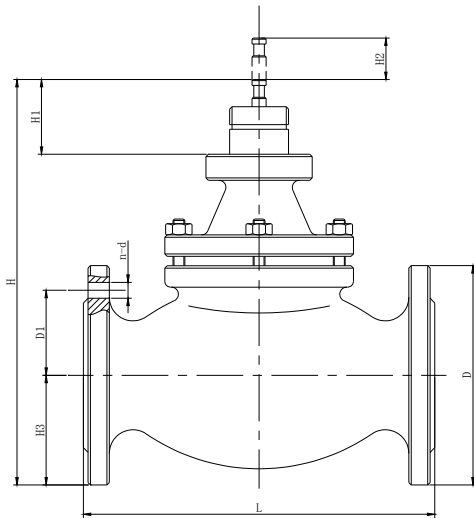

**Brass and Stainless Steel Trim
2 Way Valve**

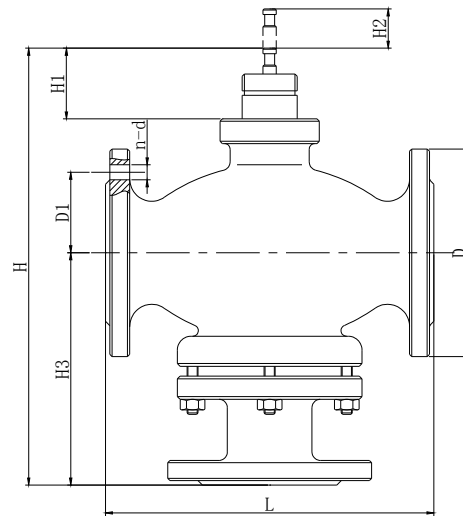

**Brass and Stainless Steel Trim
3 Way Valve**

Head Office

TELIMA AG / NENUTEC
Schachenstrasse 80, Ch-8645, Jona, Switzerland
Tel: +41 55 224 4060 Fax: +41 55 224 4069
Email: info@telima.ch
website: www.nenutec.com

Asia/Pacific

NENUTEC Asia Pacific
32 Upper Serangoon View
#15-42 Singapore 534 209
Tel: +65 6489 1815 Fax: +65 6489 1816
Email: nenutec@singnet.com.sg