

NTS 950 Series Active Temperature and Humidity Sensor



NENUTEC is proud to offer the NTS 950 series Active sensor. They are designed for use with NPC680 series controller for a variety of heating and cooling applications controlled by water valves and damper actuator.

Feature

- Active Temperature and Humidity for Room, Duct or pipe mounting
- 0-10Vdc or 4-20mA available for active sensor
- Temperature and Humidity available in single housing of duct or room mounting
- Thermo well available for NTW950-55mm or NTW950-115mm for Pipe Application

Specifications

Power Supply	DC 24V
Temp Range for Room Type	0 to 50°C
Temp Range for Duct Type	-20 to 50°C
Temp Range for Pipe Type	0 to 50°C or 0 to 100°C (Indicate when ordering)
Humidity Range	0—100%
Temp Sensor Element	NTC Thermistor 10KΩ at 25°C
Accuracy	±1°C
Analogue Output	DC 0 -10Vdc or 4—20mA
Body Material	Self-extinguishing, Molded ABS
IP Protection	IP30
Ambient Temperature	-20°...50° as per IEC721-3-3
Ambient Humidity	5...95% rH (non Condensing)
Inventory Temperature	+70°C as per IEC 721-3-2
Certification	CE and ISO 9000 (EN...requirements)

Active Sensor					Output Signal	Hyphenated	Housing	Tempera-	Humidity
N	T	S	9	5	1	-	R	T	H

Table 1:Sensor Code Number Designations

Sensor	Housing Type
NTS 950 series	R = Room, D = Duct, P=Pipe
Output Signal	Humidity or Temp Range
1 = 0-10Vdc	H = Humidity (Room and Duct Type Only)
2 = 0-10Vdc for RH and NTC10K Temperature	A = 0 to 50°C (For Pipe Type Only)
4 = 4-20mA	B = 0 to 100°C (For Pipe Type Only)
5 = 4-20mA for RH and NTC10K Temperature	

Wiring Diagram and Dimension

Terminal

- V+ - +24V
- GND - Ground
- H1 - Analog Output for Humidity
- T1 - Analog Output for Temperature

Current mode

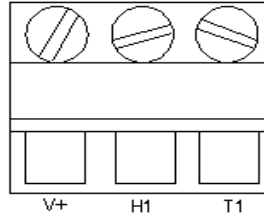

Voltage mode

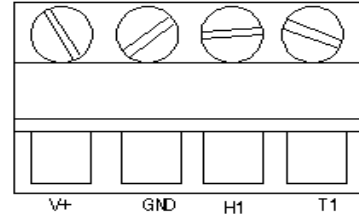

Temperature and Humidity Sensor

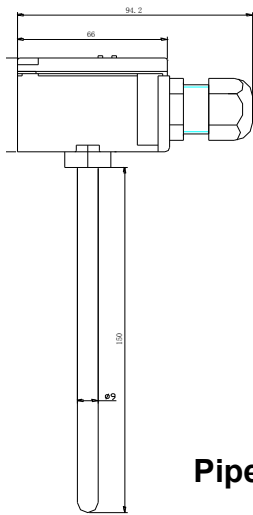

Pipe Type

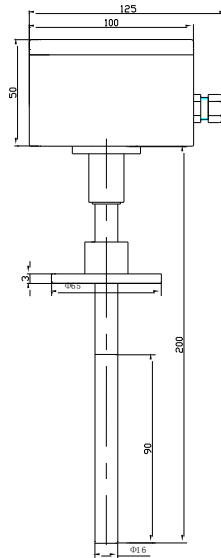
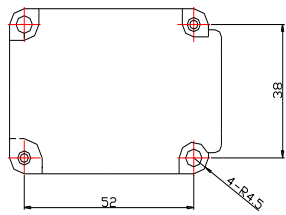

Duct Type

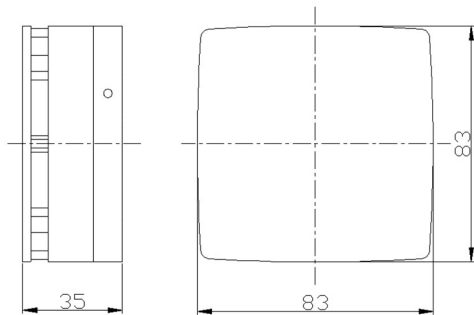
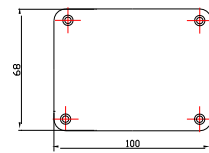

Room Type

Main Office :



NENUTEC ASIA PACIFIC PTE LTD
 7030 Ang Mo Kio Ave 5 #08-55
 Northstar@AMK
 Singapore 569 880
 Phone : +65 6570 3233
 Fax : +65 6570 6783
 Email : info@nenutec.com.sg
 Website : www.nenutec.com.sg

Headquarter:



TELIMA AG
 Schachenstrasse 80
 CH-8645 Jona / Switzerland
 Phone : +41 55 212 40 60
 Fax : +41 55 212 40 69
 Email : info@telima.ch
 Website : www.nenutec.com